

*Here's wishing  
you a Happy  
and Hopeful  
New Year*

2020



2021

# News from Bottisham Medical Practice Patients' Participation Group

**DOPPLER MACHINE:** This is the new machine we have purchased with your donations. It will be used to check the blood supply in the feet especially for diabetic patients.

**A & E and 111 Service:** NHS advise that if you feel you need to attend A & E firstly to call 111 who will arrange an appointment time there if they assess your problem can not be dealt with in other parts of the NHS. Only go straight to A & E in a life threatening situation.

**Next meeting:** Will be held virtually via Zoom to be arranged.

**We wish you all a Happy and Healthy New Year, please stay safe and follow the guidelines.**



*Bottisham Patient Participation Group.*



## We're here to help you stay well this winter



### GP

Call your GP practice or visit their website to arrange an appointment. This may take place over the phone or via video. If needed, you will be seen face to face.

### PHARMACY

Prescriptions, over the counter medications and first aid help, everything you need is still available at your local pharmacy.

### 111

NHS 111 can help if you're not sure what to do. Call 111 or visit [111.nhs.uk](http://111.nhs.uk) 24/7. If you're in a mental health crisis call 111 and select option 2.

### URGENT TREATMENT CENTRE OR MINOR INJURY UNITS

Located in Ely, Wisbech and Peterborough you can get help with minor injuries and illnesses, as well as xrays

Visit [www.nhs.uk](http://www.nhs.uk) for more information

## **A HAPPY AND HOPEFULLY BRIGHT NEW YEAR TO ALL OUR READERS**



By the time you read this we should have a clearer idea of the timescale of the role out of the long-awaited vaccine for the Covid19 pandemic. It will be a huge undertaking of immunisation, but one which will hopefully put an end to the impact that has affected the lives of all of us in 2020. And in many cases, it has been more than just an effect.

We are fortunate in this area to have avoided being in the large numbers who have succumbed to Covid19, but we will all know of somebody who has.

It has been interesting to see as time went on, the acceptance by the majority of people to follow the guidelines and rules in the interest of slowing the rates of infection.

There are always the self-centred few who ignore the rules, either younger, saying "I'm fit and well and it won't affect me" or the older, "I don't care, I'd rather enjoy the rest of my life".

Even they start to get the message when they see people recovering in hospital, who go from not realising how damaging it can be, to wanting to let the world know that it is a ghastly debilitating virus which can kill even the healthiest person (but more likely the older and weaker).

I hope you were able to meet up with those you wanted to see over the Christmas period. They say that family Christmases are up there with house moves and divorces on the stress-o-meter, so there was always the excuse if you wanted to duck out. But that would risk putting you firmly in the 'Bah Humbug' category.

The content of the Cresset recently has been a bit short on articles, as the usual organisations and clubs have not been functioning. This has given me the opportunity this month and next to include in two parts, a report from Mike Young on the work carried out on Holy Trinity Church. If you do not go to church, and that is most of us, you may not have been aware of the condition that had developed with damp and dry rot in the wooden flooring. Have a read of what has been a very interesting, and expensive project.

Also in the Magazine this month, Sports Nut gives us the sporting updates. Of note must surely be our resident world No. 3 Snooker player, winning the recent UK Snooker Championships. Well done Neil.

Jolley Old World highlights the concerns that the erosion of our environment is gaining pace and we should all be aware of what is going on around us, much of it 'under the radar'.

The Parish council Chair reminds us of the current planned expansion and the action required.

We should all be aware of changes in our environment and where it affects our lives, we should not be reticent in voicing our concerns and views. Silence on such matters has always been seen as acceptance or approval. After the event comments have no effect.

Very much a case in point is the current proposal for a new retirement village and additional low-cost housing on green belt meadows in the middle of Bottisham. It is up for

*(continued on page 2.)*

*(continued from page 1.)*

discussion by ECDC this month, so if you have a view, make sure it is heard. Don't wait till it is too late. Going online to ECDC planning pages will bring you up to date with what is proposed.

Having said we have been short on articles recently it is good to see there are organisations like BALA planning to get started again albeit by 'Zoom'.

The Social Club is continuing to offer its takeaway service, like 'Click and Collect' for a pint! Ironically It is the social aspect of the Social Club that we are all crying out for, but hopefully that will come once we all get this vaccine. We need to stay patient and stick to the rules as we enter the home straight.

**Once again stay safe, (and warm!)**

## *Here is a Challenge for you*

I have received some old Bottisham photographs including this one from 1932 taken outside the school

There will be many Bottisham residents who will know of family who were at the Bottisham School in 1932 and may have their own pictures of them.

Do you recognise anybody? Who was the teacher? If so, do get in touch and let me know. Also, if you have any interesting stories of old Bottisham and its residents, then I would love to hear them and even publish them in our village magazine for everybody to enjoy.



## *Contents*

RENEW Church.....	4	Sales, Wants and Swaps.....	15
Services in the Anglesey Benefice....	5	Bottisham Community Sports and Social Club.....	19
Anglesey Group Mothers' Union.....	5	Cambridgeshire Fire & Rescue Service.....	21
An Update on the Work at Holy Trinity Church .....	6-7	Richard "Dick" Bradford.....	23 & 25
Bottisham Community Library .....	9	Public Transport Matters.....	31
Your Feedback Helps NHS and Care Teams Support us all .....	9	Thoughts of a Sports Nut .....	41 & 43
Parish Notes .....	11	Jolley Old World.....	45 & 47
District Councillors' Report.....	13	East Anglian Air Ambulance .....	49
Planning Notes .....	15	Bottisham Adult Learning Association (Bala).....	51

## *Bottisham WI*

This has been a different and difficult year. We have had no meetings since February, no Annual Meeting (so the committee have had to soldier on) and no Summer Outing.

We have however kept in touch individually, have had a monthly newsletter with quizzes and photos of members ways of passing the time, and the Monthly Friday walking group have met weekly (outside of lockdowns of course) together with others to walk locally. Some other WI's have taken advantage of zoom meetings and we hear about these from Cambridge WI newsletters.

We have continued with monthly raffles and remembered members birthdays.

For December each member received a goodie bag from a committee member with the newsletter (with 2 quizzes), a Christmas card, a small poinsettia plant and a Christmas cracker with Lindt chocolates. Totally unexpected and a lovely idea.

We shall be meeting on the 3rd Wednesday of each month in the Main Hall at the club as soon as we can. Watch this space.

We hope to see all our existing members and hope that we will be able to welcome some new (perhaps) younger ladies.

Keep safe until we can meet again.

*Sylvia Overton*



## HAPPY NEW YEAR!

Anyone sad to see the back of 2020? Actually, to be fair there were some amazing moments during last year for me and my family and some significant ‘ministry moments’ too as I sought to help families say goodbye to loved ones, as I helped to care for some members of my church family who had struggles and as we connected with one another through our weekly zoom gatherings... I could never have imagined this time last year that for the majority of that same year, our church family would not gather together physically - but we have learnt a lot and adapted well.

### “Don’t count the days, make the days count”

We do a lot of ‘counting down the days’ in life, don’t we? Counting down the days to your birthday, anniversary, Christmas, end of quarantine or self-isolation period, end of lockdown restrictions...

Of course, it is not wrong to look forward to fun things happening, or not-so-fun things ceasing; however, if we focus too much on the countdown, we can neglect to appreciate that every day is a gift (that’s why it’s called the present!).

I want to encourage you at the beginning of this year, maybe you could make it your resolution - don’t count the days, make the days count.” Look for the good in every situation, be an encourager of others, do random acts of kindness for your neighbours, make the most of each opportunity that arises for you; make every day count in a deeply significant and meaningful way.

One of the ways you could begin this journey is by joining us on our **Alpha Course** online starting **8pm on Wednesday 13th January - Zoom Meeting ID: 785 882 4660 Password: ReNew**

Why not log in with us, see what the material has to say, share your points of agreement and disagreement, questions and responses, doubts and beliefs in this new ‘zoom way’. Grab a drink and some nibbles and join us. What have you got to lose?

**Happy New Year, I look forward to the ways and times we might cross paths in the year to come.**

*Rev. Alan*

---

**Copy deadline for next issue is 14 January.**

*Please send material to the editor  
at [BottishamCresset@gmail.com](mailto:BottishamCresset@gmail.com)*

## *Services in the Anglesey Benefice*

Subject to changing Government regulations, the following services are planned for the Anglesey Benefice in January. For up to date information, check the Benefice website: [www.angleseygroupparishes.co.uk](http://www.angleseygroupparishes.co.uk).

Sunday Services of Holy Communion will take place at 9 am in the following parish churches:

- 3 January** Quy
- 10 January** Swaffham Prior
- 17 January** Swaffham Bulbeck
- 24 January** Bottisham
- 31 January** Lode

In addition, every Sunday there will be a service via Zoom service at 10.30am. Contact [admin@angleseygroupparishes.co.uk](mailto:admin@angleseygroupparishes.co.uk) for the link to join this.

There will be a mid-week Holy Communion every Thursday in St James', Lode at 10.30am.

**Please wear a face covering for all services in church.**



## *Anglesey Group Mothers' Union*

It was with sadness we received the news that Millicent Chapman peacefully passed away on 13th November. Millicent was a longstanding Mothers' Union member for around 70 years. She held the role of Enrolling Member in Lode for 21 years 1976 to 1997. We also much appreciated her musical talents of being pianist for worship during our meetings up until three or four years ago. When Millicent could no longer attend meetings she became an indoor member and continued her support and interest in current MU projects. Sadly, to conform with Covid restrictions it was impossible for us to say our farewells to Millicent as we would have wished, but her family hope it will be possible to give thanks for her life and say our goodbyes sometime soon. We will all miss Millicent, but cherish the memories she leaves with us. May she rest in peace.

The first Mothers' Union Global Day of Action as part of the 16 Days Activism Against Gender Violence took place on 5th December. Over 20 members from across the Ely Diocese attended the Zoom service, led by Helen Banyard.

Thursday Prayers, which are normally held in Ely Cathedral, will take on Zoom at 10.30am on Thursday 21st January at 10.30am. This will be led by our Diocesan President Hazel Williams. Zoom ID 852 1960 4660 no password required.

As we move into a New Year uncertainty still surrounds when we will be able to resume our monthly meetings. In the meantime, we will continue to support those in need of our support and prayer in unison with the Mothers' Union theme for 2021. 'Rebuilding Hope and Confidence'.

**Our good wishes to all readers for 2021.**

*Ann Langran*

# *An Update on the Work at Holy Trinity Church*

## **PROGRESS OF THE WORKS TO THE N AISLE PEW PLATFORM OF HOLY TRINITY, NOVEMBER 2020**

This is taken from a report by Mike Young to the Parochial Church Council on the progress of the works to the N aisle pew platform and the external drainage of Bottisham Parish Church, Holy Trinity. The contractors are Lodge & Sons of Stebbing, who are specialists in the restoration of historic buildings. The project has been underway since 5th October .



The first move was to envelop pretty well everything above ground in Holy Trinity in plastic sheeting - an A-grade packaging job. This was followed by moving the pews in the N aisle to the rear of the nave, removal of the rotten and dry rot infected flooring, joists and the boarding (dado) along the North wall. The solid supports for the joists were also removed. (I don't know how he did it,

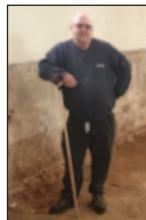

but Richard of Lodge [right] moved all the pews by himself!)

At this stage everything looked pleasantly straightforward, but there is a requirement that any excavation in or around a church has to be viewed by an archaeologist. Once a further layer of soil was removed, the picture looked rather different.



**THE GRAVES.** The large rectangular grave was the first to be revealed. (One of the archaeologists for some reason decided to stand on the grave at an early stage of removing the soil and promptly went through the surface - happily not far and without injury, but the cavity at the NE corner goes down c 70 cm.) It is not obvious in the photo, but the level around the grave and other cavities is hard clunch (local chalk), resulting from smaller pieces that have fused together, to provide firm support for a floor.

The first church on the site with aisles, dates from around 1250 and it seems likely that the clunch foundation is from this period, although it is possible that it was renewed when the nave was completely rebuilt in the first quarter of the next century.

The graves appear to have been cut into the foundation layer, so would have to be post c 1250. The decision was taken not to excavate further and to let the souls rest in peace - it would have been interesting to have dug further, but potentially expensive, since we have to pay for the archaeologists' time! However, the small square grave, just visible at the top right above was identified as that of a child from fragments of rib recovered from the soil in the grave. (All bone fragments have been collected, carefully stored and will be given a reburial at the end of the works.)



**POST HOLES.** The smaller square holes running along the N wall were identified by the archaeologists from the residues in them as holes that had held wooden posts. The line of the holes is clearer in the image lower right. (The hole with indications of wood is the smaller of the two square holes at the bottom.) The view of the archaeologists is that the posts would possibly have been scaffolding, probably of an early date.





**The foundations of the N wall.** There is evidence from the S aisle that the walls of the aisles of the rebuilt nave, c 1310-20, were in the same position of the aisle walls of the Early English predecessor. What is clear from the excavation in the N aisle is that the walls of the 14th century aisles used the foundations of the earlier church. This is clearer in real life than in the photographs but is shown quite well in this image (arrow right), the bottom layer of stone being from the earlier building. It can be seen in the other photographs and is also apparent in a photograph taken when the floor of the S aisle was removed during the works to take out some of the pews and to move the font from what is now the choir vestry. So perhaps no great discovery, but great to see.



The Allington Chantry Chapel. Much the most interesting finding was visually less dramatic and not easy to see on a photograph. Indeed initially nobody seemed that interested in it, but towards the E end of the N aisle there are no graves apparent, but quite abruptly an amount of rubble in the soil. The broom handle indicates where it starts. To the right, at the end of the excavation, is the Allington Chantry Chapel.

A chapel was created for William Allington ('Alyngton'), speaker of the House of Commons, in 1474, in which a chaplain was to say the divine service every day for the souls of William and 'our very dear consort Elizabeth Queen of England'. What was created was an aisle chapel and it must always have been highly probable that the chapel was larger than the enclosure resulting from the comprehensive reordering of the church by the Rev. John Hailstone in 1839 (above right). I recollect a speaker leading a group of visitors saying that they thought that the chapel would have extended as far as the first pillar in the N aisle and that they thought that they could see an indication, unspecified, of this.

The floor level of the chapel is higher than that in the nave and aisles and it seems highly probable that the revealed rubble was foundation material for the raised level, which extends exactly as far as the first pillar of the N aisle, (marked on the plan). So, at last there is, I think, good evidence for the extent of the aisle chapel. Indeed, there are holes on the N side of the first pillar of the arcade which could well have been fixings for the screen which would have surrounded the chapel. The presumption is that the screen was formed from the original C14 rood screen separating the chancel from the nave, which was replaced in this period by the stone chancel screen that we have today.

There has to be a silver lining to the dark cloud of the dry rot damage to the N aisle pew platform and having a glimpse into the past of Holy Trinity is it. Perhaps not as dramatic a revelation as when the 'lost' N door of the chancel and the aumbry were revealed during work to replaster the N wall of the chancel in 1986, but surely interesting.

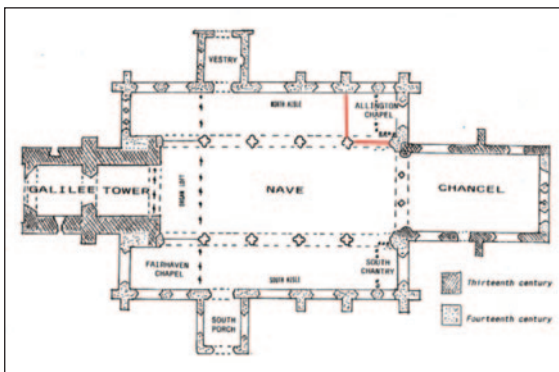

*Mike Young*



**Bottisham**  **Pharmacy**  
Here to serve your healthcare needs

You shouldn't have to **queue** this winter for your medication.

**With Our FREE Prescription Delivery Service**

**YOU WON'T HAVE TO.**

**YOUR PRESCRIPTION    YOUR CHOICE**



Call us now on **01223 812 321**

Or visit us at [www.bottishampharmacy.com](http://www.bottishampharmacy.com)

## ***Bottisham Community Library***

We finally re-opened on Thursday 3rd December after the second lockdown and have been pleased to see some of our regular borrowers.

We had to close slightly earlier than we intended for the Christmas break because the College is undergoing deep steam cleaning during the Christmas holiday.

We open again on Tuesday 5th January and hope it will be possible to get back to “normality” in the new year.

Opening times will be curtailed for a while to the following sessions

**TUESDAYS 6.00 - 8.00**

**THURSDAYS 3.00 - 5.00**

**SATURDAYS 10.00 - 12.00**

We hope to reinstate the Tuesday and Friday evening sessions when all our volunteers are back on board. We hope too to have the community computers and photocopying machines back in use. A lot will depend on the Government rules and regulations.

We intend to set up the “click and collect system” for books to be collected from our Library in Bottisham early next year. It has been used and tested in other Community libraries and will be a good additional facility.

Thank you to those who have contacted us about donating good quality books. Please keep them whilst we work our way through checking out those we already have.

With best wishes for 2021- it will surely be an improvement on 2020

Looking forward to seeing you.

*Sylvia Overton*

## ***Your Feedback Helps NHS and Care Teams Support us all***

Have you seen your GP lately? Had a hospital or dental appointment? Perhaps you have care services at home or visit a loved one in a care home.

If you, a family member or friend have used a local health or care service, Healthwatch Cambridgeshire wants to hear about your experience – good or bad.

We’re the local health and care champions. And by sharing your feedback with us, local NHS and care services can find out what’s working well or needs improving.

Please support our new campaign 'Because We All Care' by giving your feedback about the services you are using.

It’s being run with the Care Quality Commission and follows on from our big Covid-19 survey across Cambridgeshire and Peterborough earlier this year.

It only takes a few minutes to share your views with us. And your feedback helps services to continue providing the right support to local people.

Share your views online at

[www.healthwatchcambridgeshire.co.uk/share-your-views](http://www.healthwatchcambridgeshire.co.uk/share-your-views)

You can also call Healthwatch on 0330 355 1285, text your views on 0752 0635 176 or email [enquiries@healthwatchcambspboro.co.uk](mailto:enquiries@healthwatchcambspboro.co.uk)



# Saplings

Preschool Playgroup

Based in Bottisham School grounds, we offer lots of fun and structured play with caring, qualified staff in a safe environment.

For 2 years old onward, Monday to Friday  
Morning sessions 9am - 12noon

Spaces available for this term

Call **01223 813 226** or see our website at **www.saplingsbottisham.co.uk**



## Stitchshed Sewing

(Formerly Little Stitches)

### Repairs and Alterations

I am based locally and can help you with clothing alterations & repairs, curtains, blinds and cushions

### Sewing Classes

If you wish to learn to sew, then please call for a chat.

Classes at the Stitchshed or private home tuition available for:

- Dressmaking
- Patchwork and Quilting
- General craft sewing

Getting to know your sewing machine!

**Tel:** 01638 745160  
**Mobile:** 07449 954590  
**Email:** [stitchshed@gmail.com](mailto:stitchshed@gmail.com)  
**Web:** [www.stitchshed.blogspot.com](http://www.stitchshed.blogspot.com)

Little Legs  
 MONTESSORI



Fassage Hall, Lode

*A calm, child led environment where children learn through meaningful play.*

- Montessori Preschool For children aged 2-4 years
- All types of government funding accepted
- Experienced, highly qualified staff.
- Using the Montessori method of education
- Weekly Forest School sessions

#### GET IN TOUCH:

07572 121463

[littlelegsmontessori@gmail.com](mailto:littlelegsmontessori@gmail.com)

[littlelegsoflode.com](http://littlelegsoflode.com)

#### OPENING TIMES

Monday and Wednesday

9am-3pm

Tuesday, Thursday, Friday

9am-12.30pm



There were a couple of items discussed at the December Parish Council meeting which I want to share with you. The first relates to the Planning Application for a Retirement Village to the rear of 163 to 187 High Street. This was originally intended to be discussed by East Cambridgeshire DC Planning Committee in October. We were advised at the beginning of October that the matter had been postponed, to allow for the applicant to respond to “late consultation responses received”.

We were notified on 20 November that revised documents and plans had been received “to address the [District] Council’s recommended reasons for refusal”. On examining these documents, it emerged that substantial changes had been made to the application. Most notable was the addition of up to 50 affordable dwellings in the north west corner of the proposed development, on land that had previously been designated as public open space. The District Council asked for comments by 11 December, to prepare papers for the Planning Committee meeting in January. Given the extent of the proposed changes, and concern that residents should have time to respond to them, the Parish Council asked that the Planning Committee discussion be deferred until February 2021. This has been agreed and will permit the Parish Council to consider its response at its meeting on 4 January 2021.

We encourage you to look at the documents for yourself. They can be found at: <https://pa.eastcambs.gov.uk/online-applications/> then enter the application reference 20/00296/OUM. We also encourage residents to make their own comments to the District Council. If you do, it would be helpful if you could copy the Parish Council into your response at: [clerk@bottishampc.co.uk](mailto:clerk@bottishampc.co.uk).

The second item of wider interest was the presentation to the Parish Council by Jonathan Cook from the A to B1102 Group. At a time when the Greater Cambridge Partnership is considering its plan for the eastern approaches to Cambridge, this group aims to ensure that the villages from Quy to Burwell (very much including Bottisham) take the opportunity to ensure that the impacts on our part of East Cambridgeshire are understood and taken into account in those plans. Responding to consultations by the Partnership is very important and the group is supporting that process by collecting views from around our villages. Please take a look at their website at: <https://atob1102.org>. It would help them if as many local people as possible complete their short survey through the website.

Another piece of news I want to share with you is that Fenland has been identified as a biosphere.

A Biosphere is a special status awarded by UNESCO to a unique and valuable landscape. UNESCO states that "biospheres connect people, economies and nature to create a secure future we can all look forward to. They are about developing new ways of living, exploring new ideas and working together." Bottisham lies on the edge of this area. More information can be found at: <https://www.fensbiosphere.org.uk>.

In the meantime, the Parish Council is keeping busy with its work to ensure the village is a pleasant and safe place to live. In this task we work closely with C/Cllr Mathew Shuter, and D/Cllrs Charlotte Cane and John Trapp – the Council is grateful for all their help and support through the year.

Finally, I hope that you have enjoyed a peaceful Christmas despite the restrictions and send good wishes from everyone on the Council for a happy and healthy 2021.

*John Ogborn, Chair, Bottisham Parish Council*

# SG LAW

Plumbing & Heating Services

Cambridge based plumbing,  
heating and specialists in  
bathroom installations

## Services include

- Plumbing
- Heating & Servicing
- Bathrooms
- Commercial

T: 01223 812280 M: 07747552232 E: hello@sglawplumbing.co.uk [www.sglawplumbing.co.uk](http://www.sglawplumbing.co.uk)

## Saffron Salt Supplies

### Water Softener Salt

Salt tablets in 25 or 10kg bags

Block salt in 2x4kg packs

### Dishwasher Salt

Granules in 10kg bags

### De-icing Salt

White crystal in 25kg bags

delivery **FREE** to your door  
visit our website for full listing

[www.saffronsalt.co.uk](http://www.saffronsalt.co.uk)

Place your order by phone

**07980 581815** or email

[info@saffronsalt.co.uk](mailto:info@saffronsalt.co.uk)



## N.C.S.

**BRUSH ELECTRIC SWEEP  
ALL CHIMNEYS SWEPT**

- BIRDS NESTS REMOVED
- OIL & GAS BOILERS
- SOLID FUEL, STOVES FITTED
- SMOKE PRESSURE TESTING
- INSECT MESH, POTS, COWLS
- FLUE LINERS SUPPLIED & FITTED
- BIRD GUARDS & TERMINAL FITTED
- GUTTERS CLEANED & REPAIRED
- GENERAL PLUMBING WORK

**FOR FREE QUOTE CALL  
07824 727277 or 01638 662760**

EMAIL  
[NCS.NEWMARKET@YAHOO.CO.UK](mailto:NCS.NEWMARKET@YAHOO.CO.UK)

WEBSITE  
[www.ncsnewmarket.co.uk](http://www.ncsnewmarket.co.uk)

\*Send text or e-mail for 10% discount  
Answers within an hour. • Waiting time approx. 1-2 weeks

**VERY CLEAN • Public liability insurance  
- Competitive rates -**

# *District Councillors' Report*

At the last meeting of the Operational Services Committee:

- It was decided to support the Local Electricity Bill and to write to local MPs to ask them to support the bill.
- The grant to the Voluntary and Community Action East Cambs was renewed.
- The reports on Waste Collection and Street Cleansing showed very good performance.

At the last meeting of the Finance & Assets Committee:

- The External Audit noted some areas that required improvement, but nothing major, and the report was accepted.
- The ECDC accounts for the last year were submitted and approved. There was some disquiet voiced about the further loan to East Cambs Trading Company, the Council's company for building development.
- The Council Tax Reduction Scheme was continued.
- A new trustee was appointed to East Cambs CLT which has only four members; some misgivings were voiced over the appointment of the Leader of the Council to a supposedly-community led organisation. Clarification of the purpose of this trust, its governance and its relation to Palace Green Homes and East Cambs Community Housing was sought.
- The Bus Services Review document was accepted and will be submitted to the Cambs and Peterborough Combined Authority. Besides the continuation, and augmentation, of the no. 11 bus to Cambridge, other interesting ideas such as a fast bus from Bottisham to Cambridge North, and Demand Responsive Transport to the south of the A14 were proposed.
- A CIL contribution of £750,000 to the much-needed expansion of St. Mary's Medical Practice, Ely.
- The Gender Pay report for ECDC showed that there was still a gap in pay between genders.

All Council meetings are now on Zoom, and available to view retrospectively as well as being screened live, so you can see your Councillors in action. For details go to the Council website, [www.eastcambs.gov.uk](http://www.eastcambs.gov.uk).

We shall be holding our next Councillor's Surgery by Zoom on 12 January from 6.30 p.m. The Meeting ID is 357 775 2400, and the Passcode is 098359. If you prefer to follow a link, it will be on Charlotte's Facebook page – [fb.me/charlottecanelibdem](https://fb.me/charlottecanelibdem). If you join for the Surgery, you will be held in the waiting room if there is already someone in the meeting with us, so that any discussions with us during the Surgery remain confidential. The Surgery will be followed by 'Meet your Councillors' on the same Zoom link, and this will be a group meeting to listen to, and discuss, your ideas and opinions with others.

As we write this, the Covid vaccine is starting to be rolled out, which gives huge hope to all of us. But it is critical that we continue to follow social distancing, mask wearing and hand washing as well as other restrictions. If we keep protecting ourselves and each other, 2021 should be a healthy year for all of us.

*Happy New Year - Charlotte Cane and John Trapp*

# M&P

## LANDSCAPE AND DESIGN

Patios, Block Paving, Fencing,  
Turving and all Gardening needs.

References available on request.

Local tradesman • Free estimates

PLEASE CALL

**01223 811144**

MOB **07837 358550**

## N & G Marsh of Burwell Engineers

For all your metalwork requirements

- ❖ Welding Services
- ❖ Handrails
- ❖ Security Bars
- ❖ Gates
- ❖ Mower Repairs
- ❖ Tow bars
- ❖ Metal Railings
- ❖ RSJs Supplies

Services to the Building Industry  
Tractors & Agricultural Machinery  
Repaired

Tel; 01638 741354 or 741 926

## **R. BRISTLEY** Est. 1974

9 Collings. Place Newmarket CB8 0EX

### **BRUSH ELECTRIC SWEEP**

- *All Chimneys swept*
- *Solid Fuel, Oil and Gas*
- *Cowls, Nets and Pots fitted*
- *Carpets Cleaned*
- *Stoves Serviced*
- *Competitive Prices*
- *Very Clean*
- *Public Liability Insurance*

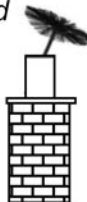

*also Classic Wedding Car Hire  
White Citroen DS21*

Tel: 01638 662439  
[www.rbristley.co.uk](http://www.rbristley.co.uk)

## **JCM**

*Property Maintenance  
Ltd*

**For the best in  
Renovation,  
Redecoration  
& Repair**

Contact Joel Clarke-Morgan  
On 07885 586229  
or e-mail; [JCM@weyr19.co.uk](mailto:JCM@weyr19.co.uk)

[www.jcmpropertymaintenance.co.uk](http://www.jcmpropertymaintenance.co.uk)  
47 Edinburgh Rd, Newmarket CB8 0QE



# Planning Notes

## PLANNING APPLICATIONS RECEIVED

20/01309/FUL & 20/01209/FUL, 1 Bottisham Place, Proposed change of use of existing redundant Grade 2 listed agricultural barn to B1 (light industrial) for manufacture of timber pods (no alteration to barn). Amended plans for Highways in respect of new access previously approved ref. 17/01876/FUL .

20/01467/FUL, Old Orchard House, 55A Lode Road CB25 9DJ. Single storey extensions with balustrade to front and rear.

20/00296/OUM Land rear of 163 to 187 High Street Development of retirement care village: Amendment and additional information to address ECDC's recommended reasons for refusal of permission. Extension for comments to 7 January 2021.

## PLANNING APPLICATIONS APPROVED

20/01246/LBC, Bottisham Post Office 12 High Street. Removal of Christmas Tree lighting, projecting lottery sign, canopy, 3 flood lights, alarm bell and replace CCTV cameras. Install new projecting illuminated Co-op sign (retrospective)

20/01247/FUL, Bottisham Post Office, 12 High Street, Subdivision of existing flat into two flats.

20/01394/LBC, Stocks, 76 High Street, Fix internal white wooden louvred shutters to front windows.

# Sales, Wants and Swaps



**IF YOU HAVE ANYTHING TO SELL OR WANT TO BUY OR EVEN TO SWAP, THEN THIS PAGE IS YOURS TO USE.** Send details of Item, price and landline Phone Number to [BottishamCresset@gmail.com](mailto:BottishamCresset@gmail.com). Max. 5 Items. Entries by 12th of the month for next months issue.

DESCRIPTION	PRICE	TEL
<b>Wooden shelving</b> suitable for use in garage or shed Needs re-assembling. Size: 190 x 225 x 20cm	Free	813183
<b>Non-fiction books</b> – large number	Free	813183
<b>Breville 25l. Combination microwave.</b> Brand New unopened box. Half price and money to go to a good cause.	£30 ono	811584



## My love for dogs An alternative to Kennels

A personal, caring approach to dog care.

In our home, your dog will receive two hour-long walks every day as well as treats, socialisation with other dogs and the administration of any required treatments.

- Fully insured and police checked
- Licensed by Sth. Cambs. District Council.

For further details call Amanda on  
07903 806750

Based In Steeple Morden near Royston.



**WILD COUNTRY  
ORGANICS**

## Organic veg box delivery

Fresh, seasonal organic vegetables, grown for flavour at our award-winning family farm in Great Abington.



Free local delivery, visit our website to order [www.wildco.co.uk](http://www.wildco.co.uk)



# WANTED

**POLITE, LOCAL BUSINESS EST. 25 YEARS  
IS LOOKING TO BUY THE FOLLOWING:**

- Furniture • Quality jewellery and Costume jewellery • Collectables • China, glass, ceramics • Old toys • Silver, silver plate, old copper & brass
- Militaria - uniforms, medals, weapons • Old tools
- Old garden ornaments • Anything considered

Polite & confidential service. Good prices paid.  
Please call: Steve Durrant 01638 507037 / 07740 591194



## Martin Ball

Firewood & Timber Merchant

www.martinballfirewood.co.uk  
martinball.firewood@btconnect.com  
01799586513 01371830503 07980258003

## D.K.TILL & SON IN LAW

### COAL AND SOLID FUEL MERCHANTS

Family run business for 40 years  
Coal, Logs, Charcoal, Gas, Compost

TEL: David Till; 01223 232947 - Kevin Crisp; 07523044521  
Email: [dktil@hotmail.co.uk](mailto:dktil@hotmail.co.uk)



LANDMARK  
INTERNATIONAL  
SCHOOL



A small international school in Fulbourn, South of Cambridge,  
**welcoming pupils aged from 4 to 16 years.**

We have experienced and enthusiastic teachers delivering a broad and engaging curriculum to small classes of pupils from Britain and beyond. We offer excellent pastoral care and are non-selective academically. Transport via school minibuses from central Cambridge and surrounding villages.

*To arrange a visit, please call:*

**Mary Greer on 01223 755100/07400 584015**

or email [mary.greer@landmarkinternationalschool.co.uk](mailto:mary.greer@landmarkinternationalschool.co.uk)

[www.landmarkinternationalschool.co.uk](http://www.landmarkinternationalschool.co.uk)

Landmark International School is a registered charity.



# SANICLEAN

DRAIN & PLUMBING SERVICES

**R. BRISTLEY** Est. 1974

9 Collings Place, Newmarket

- *Drains Unblocked Fast*
- *Toilets, Baths and Sinks*
- *Guttering and Downpipes*
- *Drain repairs and CCTV Surveys*
- *High Pressure Water Jetting*
- *Domestic and industrial*
- *All Work Guaranteed*

**Newmarket (01638) 662439**

**Mobile 07970 038404**

**[www.rbristley.co.uk](http://www.rbristley.co.uk)**

*nesh* Home Staging  
+ Interiors

Home Organisation &  
Interior Design Services

I can help with...

**De-cluttering  
Downsizing**

Or if you are

**Struggling to sell  
your home**

**07840 984258**

[www.neshinteriors.co.uk](http://www.neshinteriors.co.uk)

Qualified, Experienced,  
Insured & CRB Checked.

# FOUR SEASONS

PROFESSIONAL TREE SERVICES

Qualified & Professional Tree and Client Care

PRUNING ◊ LOPPING ◊ FELLING ◊ PLANTING ◊ REDUCING & RESHAPING  
CROWN RAISING ◊ HEDGETRIMMING ◊ THINNING ◊ POLLARDING ◊ STUMP REMOVALS  
OVERGROWN GARDENS PUT BACK IN SHAPE ◊ FRUIT TREES TREATED  
LOG & WOODCHIP SALES

FREE ESTIMATES & ADVICE WITH NO OBLIGATION

For quality jobs at a competitive price call:

01353 721665 – Mob 07771707921

All work carried out to BS 3998 Standard

A genuine family business est. for over 30 years – Fully insured

The Name you can trust.

We offer a 7day cooling off period



## *Bottisham Community Sports and Social Club*

At the time of going to press we are in tier 2 of COVID-19 restrictions which means we will remain closed until we are placed in tier 1.

We are selling takeaway beers on Tuesday and Fridays 5pm to 6.30pm during the period of closure. All at £3 a pint. Please bring your own container if possible.

When we reopen, we will follow the government guidelines at the time.



*With current restrictions when we are allowed to open the opening hours will be:*

**Monday to Friday 5pm-10pm**

**Saturday 4pm-10pm**

**Sunday 12.00 Noon-10pm**

These could change so please refer to the website.  
[www.bottishamsocialclub.co.uk](http://www.bottishamsocialclub.co.uk) for the latest information.

**We intend to hold the AGM on  
Monday 18th January at 7.30pm if the law permits.**

*Otherwise in these exceptional circumstances it will be postponed until the law permits us to hold it.*

If you are not a member, we would welcome you joining.

The membership year runs from 1st October. Initial membership costs £21. That is the £20 annual subscriptions plus a £1 share into the club. Please come along and join us, we are always very pleased to welcome new members into the club.

If you have not renewed your membership, please renew as soon as possible please.

Any queries regarding payment please email [bottishamcsasc@gmail.com](mailto:bottishamcsasc@gmail.com)

BT Sport is available throughout the year. Why not come along and watch your favorite team with company and a great pint.

**CAMRA CAMBRIDGE AND DISTRICT CLUB OF THE YEAR**

31 Downing Close, Bottisham, Cambridge CB25 9DD Tel. 01223 812063  
[bottishamcsasc@gmail.com](mailto:bottishamcsasc@gmail.com) [www.bottishamsocialclub.co.uk](http://www.bottishamsocialclub.co.uk)

# K.J.P.

## Building/Maintenance



Including:

Design, landscapes, patios, fencing,  
gardening, decking, painting,  
decorating, tiling, all interior work,  
etc.

**Tel: 01223 812021 or  
mobile 07799 504043**

Hamish Dickson   
TREE SPECIALIST

- TREE SURGERY
- SITE CLEARANCE
- HEDGE CUTTING
- STUMP GRINDING

✓ NPTC Qualified    ✓ Fully Insured

☎ 07595 876000

✉ hamishdickson7@gmail.com

🌐 www.hamishdickson.co.uk

City  
Guilds  
NPTC  
Qualified

**FREE  
Estimates &  
Advice**



BRADSTONE

- All Driveways & Block Paving
- Site & Garden Clearance
- Driveway Cleaning & Sealing
- Fencing, Trellis Work & Decking
- Patios & Paths
- Turfing & Seeding
- Concrete Crushing
- Grab Hire & Digger Hire

**amsbuildingandlandscaping.co.uk**

**OFFICE: 01638 721 893 | SITE: 07789 261 266**



**Distraction is one of the biggest causes of fires in the home - most of which start in the kitchen.**

**You lock your door when you leave the house, but do you unplug your chargers?**

**You turn off your oven when you aren't using it but do you regularly ensure there isn't a fat build up in your oven, hob and grill?**

A simple fire safety check list can help you avoid an unnecessary fire in your home - Simple tips, simply STOP the chance of a fire.

- **NEVER overload sockets:** Multi-socket adapters, often used in homes to provide more plug sockets quickly and easily, are particularly popular during the winter period when people are more likely to plug in heating devices, lights and other items. If used incorrectly however, these can be very dangerous and cause an electrical fire through overloading the socket. 'One appliance, one socket' is the safest approach to avoid any danger of fire in your home.
- **Switch off, Turn off:** If it isn't meant to be left on (like fridges, freezers) switch it off and turn it off at the plug when it isn't in use.

Charge safely: Only use electrical charging devices for the purpose they were intended and avoid purchasing counterfeit, cheap charging devices for electrical items and always keep leads away from cookers and hobs.

- **Fat-Free, Fire-Free:** Fat can build up slowly over time through regular use of kitchen devices and as it does it increases the chance of a fire when cooking. Ensure you regularly maintain hobs, grills and ovens and keep them clear from fat build up and safer from fire.
- **Distraction causes fires:** over 50% of fires in the kitchen are caused by distraction - pay attention and avoid cooking if under the influence of alcohol or medication or feeling tired.

For more information or to get in touch contact us at [firefire@cambsfire.gov.uk](mailto:firefire@cambsfire.gov.uk) or on 0800 9179994.

Like us on Facebook for regular updates [www.facebook.com/cambsfrs](http://www.facebook.com/cambsfrs) or follow us on Twitter @cambsfrs.

Have you thought of advertising your business in *The Cresset*?  
Email the Editor for details: [BottishamCresset@gmail.com](mailto:BottishamCresset@gmail.com)

# Rayment's

• Vehicle Servicing & Repairs •

## Diagnostic Specialist

MOTs | Servicing | Tyres

Cambelts | Brakes | Air Con

8 Townsend, Soham, Ely, CB7 5DB

# 01353 655136

[raymentsvehiclerepairs@outlook.com](mailto:raymentsvehiclerepairs@outlook.com)

[www.raymentsvehiclerepairs.co.uk](http://www.raymentsvehiclerepairs.co.uk)



## *Richard “Dick” Bradford*

Firstly, I would like to thank Gerry Daish for his kind words about Dad in last month's edition of the Cresset; kind words indeed Gez and greatly appreciated by all the family. On that point I would like to express my heartfelt gratitude to all the wonderful people who sent cards expressing their sadness, respect, and love for Dad. You will never know how much it has helped the whole family at this time.

On the day of Dad's Funeral, my brothers and sister, walked behind the Hearse from our family home in Beechwood Avenue to the Holy Trinity Church, the place where Dad was Christened 90 years ago. We would have liked Dad's service to be in his beloved Church, but as things worked out, it was closed for essential repairs. As we approached the church, we were literally blown away by the large gathering of Bottisham people who had turned up to pay their respects to Dad and our family. I knew Dad was extremely respected and loved from within his own community, but in that moment, it really hit home how much. As a family will be eternally grateful to you all.

Dad was a massive part of Bottisham and its history. Only in October when the Cresset was pushed through his door, he said to me, “See that photograph of the old shop Mike”, referring to the front cover picture, “that's the exact place where I was standing when Jim Bendall said to me, “Dick boy, we're at War”. He was referring of course to the start of World War 2. What a recollection?! Nothing wrong with your memory I thought.

Dad was born in a cottage on Lode Road in 1926; it was one of a pair of cottages opposite the village college which have long since gone. Dad would recall how the road to Lode was nothing more than a dusty track in those days. Times were hard and being the youngest of 5 children Nanna and Grandad's priority was putting food on the table. As a child he would spend his days playing any sport he could, scrumping in the vast orchards of the village and swimming in the Swaffham Rivers. I bet lots of people reading this now would not realise that at the little humpbacked bridge to Swaffham Bulbeck, there used to be a river big enough to swim in.

Dad's school was next to the church, I can only imagine the range of emotions he must have felt when we took him back to the school for a slap-up Italian meal in the then Il Piccolo Mondo restaurant, which it had become by his 87th birthday. He had a tear in his eye and even bigger one when the bill turned up!

After his schooling, the opportunity of work was limited, Dad was a highly intelligent chap and at school he had been the equivalent of a Head Boy, (dear Audrey Rowe was the Head Girl). Determined to better himself he would cycle into Cambridge where he studied Aviation engineering at night school. When war came, he had to do his National service and was posted to faraway lands such as Egypt and Palestine serving in the Engineers.

My Grandad was one of 9 children born in the white Bodec cottages in Tunbridge lane. While grandad stayed in Bottisham his whole life, 3 of his brothers left Bottisham and went to Canada in the early 1900's in search of “The New World”. This was something Dad liked the sound of. When the war had finished, he decided to go to Canada and the United States

*Continued on page 25*



# Hello neighbour

Bottisham's Co-op is open

Find us here:

12 High Street, Bottisham,  
Cambridge CB25 9DA

Open 6.30am - 10pm, daily



It's what we do

to see his Uncles and this “New World” he had heard so much about. He liked what he saw and stayed for over 7 years, mainly living in Regina and Moosejaw in Saskatchewan also Toronto in Ontario. He spent a lot of time in the U.S in 1955 travelling all over New England and right down the east coast to Daytona in Florida, he loved his time in Vermont New England, recalling how a friend would fly him in a plane over a beautiful lake called “Lake Champlain”. I love that name, a place I now have a huge desire to go and see for myself.

Dad had a huge passion for music, especially Jazz and in 1955 he saw Ella Fitzgerald, Count Basie, and Louis Armstrong at the Famous Birdland Jazz Club in New York City.

On Dad's return to Bottisham he started a new career path and became a sales representative for Hoover selling a potentially new revolutionary product called a Vacuum cleaner. It proved to be a great success and Dad did very well. A few years later he was approached to go and work for another well-known British company, Raleigh, selling bicycles this time. As you can imagine selling bikes in Cambridge was not much trouble and Dad's sales were extremely good. He finished his working life at Falcon cycles retiring at 65.

In 1957 Dad met mum at a dance in Ruthin, North Wales and after a short while convinced her to leave her Welsh home and brought her back to Bottisham, where they soon married and raised their family of 5 children.

Dad also had a huge passion and desire for sports, namely Cricket, Golf, Tennis, Cycling and Football. My Brothers and I were encouraged to play and try them all with Dad supporting keenly. He loved his Cricket and had many happy years playing for Bottisham, great times with incredible characters and friends, none more so than Andrew Martin, without doubt one of Bottisham’s favourite sons.

After losing Mum in 2007 Dad continued living at the family home even embracing modern technology; he loved his laptop computer and Sky TV with sports from all over the world. I recall once remarking that he looked a bit tired, he said he had been staying up until 3 in the morning for about a week watching the Australian Open Tennis from Melbourne. “Haven’t you been watching it Mike? It’s terrific!” “Errrr no Dad I’ve got work” was my reply!!

Even now it feels so strange walking into the house and not hearing Ella Fitzgerald, Frank Sinatra and Louis Armstrong blasting out on YouTube.

Ultimately Dad ran a great race, batted a terrific, steady innings with flashes of brilliance but fell just short of his Ton! We are all honoured to have shared and to have been a part of his innings but above all, we are all extremely proud to call this Bottisham Boy ... Richard Bowyer Bradford our father.

After the most horrible and strange year for everybody, when the sun shines again and when we all feel safe to do so, we will be arranging a memorial service in the Church that Dad loved so much to celebrate a life well lived. This will be followed by a “knees up” with all of Dad’s friends at the Legion, sharing their stories of Dad whilst listening to some of his favourite music.

*Mike Bradford*

---

**Copy deadline for the next issue is 14 January.**

*Please send material to the editor at [BottishamCresset@gmail.com](mailto:BottishamCresset@gmail.com)*



## OvenPad Cleaning Services

I will professionally & efficiently clean ovens, ranges, Agas, ceramic hobs, extractors, microwaves and BBQs.

**It's a dirty job, why not give me a call?**

Contact **Paddy Kelly** on  
Tel: 01638 742703  
Mob: 07752 631343  
Email: [info@ovenpad.com](mailto:info@ovenpad.com)  
Website: [www.ovenpad.com](http://www.ovenpad.com)

## ANDREW EVANS

01954 780 999 – 01223 864335

email: [andrew@omegaclean.co.uk](mailto:andrew@omegaclean.co.uk)  
[www.omegaclean.co.uk](http://www.omegaclean.co.uk)

- ✓ Carpet Cleaning
- ✓ Upholstery Cleaning
- ✓ Tile & Grout Cleaning
- ✓ Leather Cleaning
- ✓ Oriental Rug Cleaning
- ✓ Carpet & Fabric Protection
- ✓ Allergy Relief Treatment
- ✓ Odour Eradication
- ✓ Stain Removal
- ✓ Carpet Fitting

Family Business Since 1980



# PEST PROBLEM?

CALL DRE PEST CONTROL

01954 230708

07789 502556

- Commercial & Residential
- One - off Call Outs
- Management Contracts

Cambridge & surrounding areas  
[www.drepestcontrol.co.uk](http://www.drepestcontrol.co.uk)



# Paying too much for your glasses?

## Save Money - Buy Direct!

Visit our factory shop to see our fabulous range of Discount Prescription Eyewear

- Hundreds of frames to choose from, including designer frames from Ray-Ban, Polo Ralph Lauren, Oakley, PRADA, Ted Baker and Versace
- Specialists in high and complex prescriptions
- Same-day or next-day service available\*
- Save up to 75%
- Huge range of designer sunglasses
- Full range of sports eyewear

Official stockists

\*subjecttoprescriptionandavailability



**POLO**  
RALPH LAUREN



**PRADA**  
EYEWEAR

**TED BAKER**  
LONDON

**VERSACE**

We are open 9am to 5pm Monday to Friday, and 9am to 1pm Saturday



**ALL EYES**  
SPECTACLE MAKERS  
EST. 1987

Call us

**01954 231545**

Visit our website

**www.all-eyes.co.uk**

20 Norman Way Industrial Park, Over, Cambridge CB24 5QE

## SN Handyman Services

A friendly and reliable service for all your general home and garden maintenance.

- ▶ Painting & Decorating (interior/exterior)
- ▶ Garden Maintenance
- ▶ Tiling & Glass Splashbacks
- ▶ Gutters Cleared & Repaired
- ▶ Power Washing Patios
- ▶ Sealant Replacement (bathroom/kitchen)
- ▶ Curtain Poles & Blinds
- ▶ Flat Pack Furniture (assembly)
- ▶ Shelf Fitting
- ▶ Small Glazing
- ▶ Conservatory Cleaning ▶ **and more...!**

**Free estimates & advice given on all work**

References available upon request.

**PLEASE CALL**

**Steven Newton** ▶ 07713 859712 ▶ 01223 813701

50 Commercial End ▶ Swaffham Bulbeck ▶ CB25 0NE.

# NW BROWN

— WEALTH MANAGEMENT —

Providing bespoke solutions to your  
financial planning and investment needs

01223 357131

[www.nwbrown.co.uk](http://www.nwbrown.co.uk)

NW Brown Wealth Management is a trading name of NW Brown & Company Limited. NW Brown & Company Limited is authorised and regulated by the Financial Conduct Authority (191123).

## TV AERIALS

## SATELLITE

## DIGITAL FREEVIEW

Installations

Extra points etc.

Tuning in of TVs, Digiboxes etc.

Experienced local engineer

## RICHARD FORTEY

01638 662119

No Call Out Charge

Email [info@angliarhearing.co.uk](mailto:info@angliarhearing.co.uk)

## AN INDEPENDENT AUDIOLOGY CLINIC BASED IN CAMBRIDGE

### Hearing Tests

Free Hearing Tests  
Detailed Hearing Assessments  
Most Up-To-Date Testing Methods

### Hearing Aids

Get a hearing aid in a matter of days  
Free 30-day no-obligation trial

### Ear Wax Removal

Micro-suction • Irrigation • Video Otoscope

### Tinnitus Treatment

Fast appointments. Many treatment options  
Member of British Tinnitus Assoc.



Audiology House, 15 Woollards Lane, Great Shelford, Cambridge, CB22 5LZ

**BOOK ONLINE!** [www.angliarhearing.co.uk](http://www.angliarhearing.co.uk) • Phone 01223 661399

## Morgans Hairdressers

Tel: 01223 811646

### Creative styling for the family

- Creative cutting
  - Hair up
  - Colouring
- Colour correction
  - Perming

Open: Tuesday - Saturday, Wednesday  
until: 8.00pm



10 Herschel Court, High Street,  
Bottisham, CB25 9DQ



Follow us on facebook



## footprint Signs & Graphics

01223 214 294

info@footprintsigns.co.uk

- Banners, Swing Signs & A-Boards
- Business Cards
- Leaflets & Brochures
- Labels, Stickers & Magnetics
- Shop Fascias
- Site Boards
- Vehicle Graphics
- Window Graphics & Films
- Web Design



www.footprintsignsandgraphics.com

SUMMIT



## LANDSCAPES

PAVING - DRIVEWAYS - BRICKWORK  
CARPENTRY - GROUNDWORKS



www.landscapingpaving.co.uk

PHONE: 01223-929394



## *Public Transport Matters*

A different sort of Christmas. I hope that you all enjoyed the festive season despite the limitations. Public transport has been badly affected by the lockdown with many companies suffering loss of income. As I have mentioned previously, the reopening of schools meant some coach companies now had work and the Government has been handing out payments to rail companies.

Eurostar has asked for the same support from the Government that aviation industries receive. Eurostar says it is fighting for survival and feels it is at a disadvantage compared with aviation. Airports have received rates relief.

Bus routes between Newmarket and Cambridge are some of the most requested according to a survey done by East Cambs. District Council and which received more than 1,000 responses, which included Burwell and Bottisham to Cambridge and Isleham to Newmarket. Usage of the buses is now very low due to the present situation as regards the virus. People are staying at home, using their cars and many are working from home.

The local papers regularly have articles on the plans for the new Metro system and recently there have been the naming of 5 non- executive directors. A vision of how it should be organised was set out and then revised. 1.5 billion pounds for this transport system is the expected cost not 1.5 million as first published. Some people are asking for a rethink mentioning just better ordinary bus routes would be cheaper and quicker. I have missed the free little bus that used to go round the centre of Cambridge.

The Weatherby rail crossing in Newmarket has been retained after a successful campaign. Shippea Hill near Ely had the lowest number of station visits in Cambridgeshire with just 164 visits in the year to March 2020 but the previous year it was 432. Cambridge had the highest daily number with 21,580 exits and entries. It is followed by Huntingdon, St.Neots and Cambridge North.

Taxpayers will be hit with a 4 billion pounds bill to keep the half empty trains on the rails due to the pandemic. It is suggested that trains might stop twice hourly between Newmarket and Cambridge not just once and there was a consultation in December. James Palmer is lobbying for more capacity at Ely North and Ely stations - 11 not 8 trains an hour.

Crossrail is delayed and paying millions for train drivers. They carry out tests on the 13-mile tunnel section through central London. Network Rail has promised to plant tens of thousands of trees honouring a pledge to the Daily Mail.

Richard Goodwin has published an interesting book on the history of London's stations.

**Rail info. 08457 48 49 50 Traveline 0871 200 22 33**



Have you thought of advertising your business in *The Cresset*?  
Email the Editor for details: [BottishamCresset@gmail.com](mailto:BottishamCresset@gmail.com)

# D.S. FREEMAN

## Painters & Decorators

- Residential & Commercial
- Interior & External
- Fully Insured
- All Aspects Undertaken

duncan@dsfreeman.co.uk

**Tel: 01223 812920**

Longmeadow

Copy deadline for next issue is  
14 January.

Please send material  
to the editor at

**BottishamCresset@gmail.com**



### **ALAN R. COOPER**

BSc(Hons)Pod. M.Ch.S

**Podiatrist/Chiropodist • Newmarket**

(Est. RC Cooper SR Ch.1934)

Routine Chiropody & Home Visits  
Ingrown Toenails by Local Analgesia  
& Footwarts by Cryosurgery (freezing)  
Biomechanical Assessment + Orthosis  
Instruments sterilised by Autoclave

**TELEPHONE 01638 662840**  
**4 Market St., Newmarket CB8 8EE**

### **E.J. DENSTON**

#### **KITCHENS & CARPENTRY**

All aspects of Carpentry & Joinery  
New Build 1st & 2nd fix carpentry  
Purpose made cupboards, wardrobes  
& Bookcases

Kitchens supplied & fitted  
Renovations & small build works



**Tel: 01223 813279**  
**Mobile 07711 578687**

### **Carpentry Services**

## **TONY MARTIN**

Over 30 years experience

***Any carpentry jobs  
undertaken — BIG or small***

Call Tony  
for a free estimate  
**Tel: 01223 812786**  
**(Bottisham)**  
**Mobile: 07767475987**

# ANGLIA TREE CARE

**LARGE ENOUGH TO COPE • SMALL ENOUGH TO CARE**

80% OF OUR WORK IS VIA RECOMMENDATIONS  
TREE SURGERY & FELLING • HEDGE MAINTENANCE  
STUMP GRINDING • FULLY QUALIFIED  
FULLY INSURED • 24/7 SERVICE  
All work carried out to BS 3998

**Free Estimates Given within 7 days**



Tel. 01223 424454 • [INFO@ANGLIATREECARE.CO.UK](mailto:INFO@ANGLIATREECARE.CO.UK)

**M E M B E R**  
Guild of Master Craftsmen

## PETER FISHER

CARPETS - WOODS - VINYL

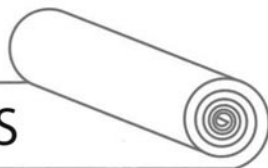

A wide range of floorings supplied and fitted.  
Please call for a free estimate and select in your home.

Tel: (Bottisham) **01223 811321**  
Mobile: **07879 494 685**

Great service for  
**30** years

**S. NEAL**  
*Carpentry and Small Works*

Offering a high quality carpentry and small works service in Bottisham and the surrounding area.

FLOORING • HANGING NEW DOORS  
KITCHEN RENOVATIONS • DECORATING •  
TILING • LANDSCAPING  
BESPOKE CARPENTRY



**07703 043243**

SNealCarpentry@Gmail.com  
@S.Nealcarpentry

**Dale Parker**

*Landscape Gardener  
and Tree Surgeon*

Turfing, Seeding & Planting,  
Patos and Drives  
Block Paving & Natural stone

**Trees**

Topping, Lopping,  
Shaping and Felling  
Hedge Cutting  
Fencing

**FREE ESTIMATES**  
Tel: **01284 728497**  
Mob: **07799 671010**



**ONG**

“Successful entrepreneurs are givers and not takers of positive energy.” ANONYMOUS

**codge.com**  
**info@codge.com**  
**01449 675 548**

Design & Origination • Website Design & Maintenance • Email Marketing • Digital Publishing  
• Logo Creation • Cartoons & Illustrations • Theatrical, Product Photography & Retouching •  
Business Stationery • Promotional Flyers & Posters • Newsletters & Magazines • Programs &  
Catalogues • Books & Brochures • Calendars • Reports • Signage, Displays & Banners •  
Personal & Wedding Stationery • Mac Training





# Are You Paying Too Much For Your Medical Insurance?

## Independent And FREE Advice

- **Switch to an alternative scheme** – If you are currently insured, switching to a competitor can mean *substantially lower rates*
- **Pre-existing conditions covered** – It is often possible to include pre-existing medical conditions currently covered by your existing provider
- **Improve your coverage** – We can frequently improve your cover whilst also lowering the cost of your premium
- **Complexities of different schemes** – In many cases, people are over insured – we can ensure you are covered with a scheme that meets your individual needs and requirements
- **Full cover for cancer treatment** – Many policies do not cover cancer in full – we are able to advise on your current level of coverage



For further information, please call Simon Lively at  
M&L Healthcare Solutions:-

**FREEPHONE 0800 145 5838 or 01223 881779**

Email: [simon.lively@mlhs.co.uk](mailto:simon.lively@mlhs.co.uk)

quoting ref: The Cresset

M&L Healthcare Solutions is authorised and regulated by the Financial Conduct Authority. (FCA Reference number 554206)

## PREMIER INVESTMENT MANAGEMENT SERVICES LTD

INDEPENDENT INVESTMENT ADVISERS Authorised &  
Regulated by the Financial Conducts Authority

Specialist in Isa's & Isa Transfer's  
Investment Planning & Portfolio Management

To arrange a free consultation ring **01223-882422** or email  
**pims@globalnet.co.uk** or visit **www.pims-uk.com**



**“Nesslands of Burwell”**



Your local Dog Kennels, Cattery and Doggy Day Care!  
Delivery and Collection Service Available !

Fully Licensed by ECDC and Veterinary Inspected.  
Ness Road, Burwell. CB25 0DB [www.nesslands.com](http://www.nesslands.com)

**Call Tim or Anya on 01638 720623**



# BOTTISHAM

## SCHOOL OF MOTORING

Tel: 811556

*All qualified instructors  
with extremely high  
1st time pass rates*

**Sab** saint  
andrews  
bureau

THE PROPERTY SPECIALISTS

# FOR ALL YOUR PROPERTY NEEDS

Lettings  
Estate Management  
Property Insurance

Your local independent property agency.  
A family business operating since 1959.

**CALL OUR OFFICES TO ARRANGE A  
FREE VALUATION**

[cambridge@sab.co.uk](mailto:cambridge@sab.co.uk)

[newmarket@sab.co.uk](mailto:newmarket@sab.co.uk)

<b>Cambridge</b>	<b>Newmarket</b>	<b>Swaffham</b>	<b>London</b>	<b>Ware</b>	<b>Royston</b>	<b>Longstanton</b>
01223 352170	01638 663705	01223 352170	0203 7863145	01920 485245	01763 242222	01954 781963

**sab.co.uk**

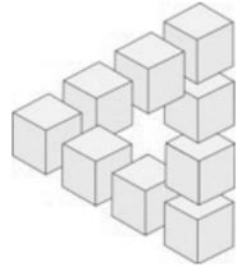

## INDEPENDENT FINANCIAL SOLUTIONS

You know that the State Pension is not enough, but you don't know what it will provide!

You want to save for your retirement, but you don't know what you will need!

You wish to protect your family against financial disaster, but don't know what cover you require!

You need to make your money work hard, but don't know which option is best for you!

You would like to reduce your tax bill, but you don't know how!

.....  
**Whether you own a company, are self employed, employed or retired, we can help!**

**We don't believe in adding to your problems.**

**We believe in clear and simple solutions.**

Let us provide you with an **INDEPENDENT**  
review of your financial situation.

**The value of investments and income from them may go down.  
You may not get back the original amount invested.**

*Tax treatment is based on individual circumstances  
and may be subject to change in the future*

**Tel: 01638 615343 or Fax: 01638 615342**

**E-Mail: [qc@independent-financialsolutions.co.uk](mailto:qc@independent-financialsolutions.co.uk)**

**Website: [www.independent-financialsolutions.co.uk](http://www.independent-financialsolutions.co.uk)**

Newnham Farmhouse, 16 Low Road, Burwell, Cambs, CB25 0EJ  
Partners: Quentin Cooke (authorised Independent Financial Adviser) & Alison Cooke





An accountancy service  
based in Burwell that  
covers everything  
your business needs

For more details contact Paul on

 [info@cb25accounting.co.uk](mailto:info@cb25accounting.co.uk)

 07803 782423  [cb25accounting](https://www.facebook.com/cb25accounting)



Sales, servicing, repairs and sharpening  
of all types of garden machinery.

Collection and delivery available.

Friendly, local and professional service.



**C.W.KIRK LAWNMOWERS**

01638 744 349

# YOUR PERSONAL WEALTH. OUR PERSONAL RESPONSIBILITY.

At Tilney, we have been helping clients achieve their financial goals for more than 180 years. Whether you are saving for retirement, want to pass on your wealth or would like to have your investments managed by an expert, we can do the same for you.

To find out how we can help you, please call our Cambridge office on **01223 452 840** or email [neil.trickett@tilney.co.uk](mailto:neil.trickett@tilney.co.uk) for Investment Management or [laura.ingram@tilney.co.uk](mailto:laura.ingram@tilney.co.uk) for Financial Planning.

Investments carry risk –  
investors can lose money investing.  
[tilney.co.uk](https://www.tilney.co.uk)



PLANNING | ADVISING | INVESTING

**ANDREW  
HULME**  
Chartered Accountant



12 Tunbridge Lane  
Bottisham  
Cambridge  
CB25 9DU  
Tel. 01223 811323  
[andrew@hulmeacc.co.uk](mailto:andrew@hulmeacc.co.uk)

- Accounting
- Bookkeeping
- Club Accounts & CASC Assistance
- VAT Returns
- Management Accounting
- Personal Tax
- Business Advice



**PET TIME**

[www.petime-petcare.co.uk](http://www.petime-petcare.co.uk)

No pet too small!

Dog walking  
Cat, dog and small animal feeding visits  
Dog home boarding  
House and pet sitting  
Doggy daycare

Contact Michele:  
07765 791227  
01638 508337

[info@petime-petcare.co.uk](mailto:info@petime-petcare.co.uk)

All animals from hamsters to horses  
cared for just as you would want.  
Fully insured, first aid trained  
and police-checked.

**STEPWISE FOOTCARE**

**Vivien Honeyborne-Martins**

MA(Cantab) BSc(Hons) MChS HPC Registered



**Clinic-based Chiropody/Podiatry**

- *Chiropody*
- *Biomechanical assessment*
- *Insole/bespoke orthotic therapy*
- *Children's foot problems*
- *Foot/knee pain problems*
- *Lunula Laser™ fungal nail treatment*
- *Swift Microwave for verrucas*
- *SIDAS orthotics made on site*

**The Burwellness Centre**

10 Ness Road, Burwell, Cambridge, CB25 0AA  
Tel: 01638 741973 [stepwise-footcare.co.uk](http://stepwise-footcare.co.uk)



**PHOENIX TILING SERVICES**

- Professional tile fitting for homes and businesses
- All types of wall and floor tiles fitted
- Local, friendly and reliable service using the latest precision tools
  - Trained by the STC Group

Contact Ray for a quote on  
07591 747625 or  
[phoenixtilingservices@gmail.com](mailto:phoenixtilingservices@gmail.com)

[www.phoenixtilingservices.co.uk](http://www.phoenixtilingservices.co.uk)

### **HAPPY NEW YEAR EVERYBODY!**

It's not too often that Bottisham can celebrate having a national champion in our midst, so may I kick off 2021 by offering heartfelt congratulations to "local" boy Neil Robertson for his magnificent triumph in the UK Snooker Championship in December. Playing snooker of the very highest calibre, as he has now done since turning professional in 2006, the current world no.3 took on world no.1 Judd Trump, in a gruelling final which endured to the last frame with the score at 9-9. A gritty tactical battle stretched into the small hours of the next morning and, with both players spent like punch-drunk warriors, Robertson finally profited from an uncharacteristic error by Trump who missed a very gettable pink with victory in sight. This was an epic sporting event of tension, drama and breathtaking skills... such a shame that the only audience was watching on TV. Let us hope that the coming year allows us to enjoy the atmosphere of packed arenas in all sports once again.

Coincidentally, that final took place on the very weekend that saw spectators in domestic football matches for the first time since last March and this was a happy modicum of progress for nearly everyone. But there was a somewhat disconcerting furore over the crowd at the Millwall-Derby match which booed the players for the now customary 'taking of the knee' before the game. (By the way, the same thing happened at a number of other grounds, too, but those were under-reported in favour of an easier target at Millwall.) Social media was alive afterwards with players, managers, league officials, The FA, broadcasters and journalists crying, "Racists!" But I'm not sure it's as simple as that, is it?

No-one can argue against the propriety of sports people using their high profiles to oppose racism and other discriminator behaviours, but it seems the 'knee' gesture is beginning to wear a little thin with the general public now, particularly in view of its association with the controversial Black Lives Matter movement. The football authorities have already dropped slogans overtly supporting BLM and they would do well to consider whether to continue the knee-taking before stadiums return to full capacity. Just imagine the hullabaloo if crowds of 50,000 plus start voicing their objections (as opposed to the 2,000 at Millwall)!

Another issue that polarises contemporary opinion is whether Lewis Hamilton is a national treasure who should be regarded as our greatest sportsman, worthy of an immediate knighthood, or a virtue-signalling tax avoider who wins only because he is driving the best car in Formula 1. I guess the answer is, as always, somewhere between the two extremes, but I would say – as I did of Bradley Wiggins back in 2013 – that surely it makes sense to allow someone to finish their career before bestowing the ultimate accolade upon them!

At the time of writing, Hamilton's latest Grand Prix victory came in Bahrain, where Frenchman Romain Grosjean made an extraordinary escape from his burning car after a terrifying 137mph crash. Whilst everyone was left marvelling at the effectiveness of the controversial "Halo" head protection, there were also concerns over the failures of both the crash-barrier and the car, which had unexpectedly broken in half and burst into flames, trapping the driver for 30 seconds. The fact that Grosjean suffered only minor burns and is

*(Sports Nut continued on page 39)*

# SECURE CONTAINER STORAGE

**10ft and 20ft**

IDEAL FOR BUSINESS OR PRIVATE STORAGE.  
CONVENIENTLY LOCATED IN BOTTISHAM

**Call 07841 930065**



## **Rothwell's** Carpet Cleaning

**Thorough, professional cleaning of Carpets, Upholstery, Rugs, Tile & Grout and Natural Stone floors.**

- 'Truck mount' cleaning system
- Family firm est 1993
- Great customer service
- We move all the furniture
- Fully Insured
- Highly trained & experienced
- **100% satisfaction or its free**

*If you use us,  
you'll recommend us!*



**NCCA**<sup>®</sup>  
NATIONAL CARPET CLEANERS ASSOCIATION  
CLEANING THE NATION'S CARPETS AND UPHOLSTERY

M2391

For a quote  
or advice please  
**07545 962 026**  
**01223 832 928**  
[www.rothwells.biz](http://www.rothwells.biz)

***(Sports Nut continued.)***

well on his way to a full recovery, is testament to the enormous steps in F1 safety achieved over the last couple of decades, but it's worth recognising that the biggest steps are always taken in the aftermath of tragic accidents when research efforts are redoubled to improve future safety. Respect to all the top drivers for risking their lives on a monthly basis in the pursuit of sporting excellence.

Talking of safety, I was disappointed to see 'Iron' Mike Tyson join the long list boxers who attempted to defy Father Time by returning to the ring after years of retirement. Admittedly it was only an exhibition bout for the 54-year-old, against Roy Jones Jr, 51, and it was described in the press as an "engaging draw". However, one really has to doubt the sanity of the two pugilists taking such risks with their health and, equally, doubt the integrity of the authorities who sanctioned this folly. You don't suppose this was all about the dirty Dollar, do you? Fortunately, no apparent damage was suffered by either party and I must say I chuckled at the comment of Rap artist Snoop Dog who, in his capacity of celebrity ringside commentator, observed "It was like two of my uncles fighting at a barbecue"!

A more meaningful and exciting encounter took place at Twickenham in early December when England secured the Autumn Nations Cup in an enthralling game of Rugby against France in front of 2,000 spectators. The tournament was cobbled together in consolation for a Covid-hit season in which southern hemisphere teams were unable to undertake their normal tours north and it was all rather low-key until the thrilling finale in which Owen Farrell finally (after three misses!) kicked the penalty tipping the balance in the home team's favour. Well done England... that's two trophies in two months (following the Six Nations title in October)!

If you'll forgive me for a little plagiarism, I must share with you, my treasured reader, a couple of wonderful quotes, found in a BBC article, from commentator Peter Alliss who left us before Christmas at the ripe old age of 89. I confess, I've never been particularly captivated by golf, but Alliss was one of those characters who transcended his own sport and delivered its essence to a far wider audience than just the enthusiasts, even to heathens like me! RIP Peter 'The Voice of Golf' Alliss.

"It's like turning up to hear Pavarotti sing and finding out he has laryngitis." - reflecting on Tiger Woods shooting a third-round 81 at the 2002 Open.

"One of the good things about rain in Scotland is that most of it ends up as Scotch." – his comment on poor weather during a tournament in Scotland.

Finally, you may be expecting a bitter English vituperation of Diego Maradona after his untimely demise in late November. However, it would be churlish not to recognise the immense talents and achievements of this extraordinary man – a flawed genius if ever there was one. His legacy, surely though, is a clear illustration that a very clever footballer is not necessarily the same thing as a great sportsman!

*TTFN. Gerry Daish*



**Copy deadline for next issue is 14 January.**

*Please send material to the editor at [BottishamCresset@gmail.com](mailto:BottishamCresset@gmail.com)*



# DRAIN-PLUMB

*Plumbing, Heating & Drain  
Services*

## BLOCKED DRAINS CLEARED

- Gas Boiler Service & Maintenance
- Power Flushing of Boilers & Heating Systems
- Home Buyers CCTV Drain & Plumbing Surveys
- All Plumbing & Heating Repairs/Alterations
- All work Guaranteed

TEL: 01638 742873  
MOB: 07932 773515

7 NESS ROAD,  
BURWELL  
CAMBRIDGE, CB25 0AA

## BED AND BREAKFAST

### THE MEADOW HOUSE

2A High Street, Burwell,  
Cambridge. CB25 0HB



- En-suite rooms with colour TV.
- Large car park and grounds.
- Family rooms, children welcome.
- English Tourist Board 4 Diamonds.

*Self catering cottage also available  
at Swaffham Prior.*

Brian and Hilary Marsh  
Tel: 01638 741926  
Fax: 01638 741861  
Website: [www.themeadowhouse.co.uk](http://www.themeadowhouse.co.uk)

## SQUEAKY MOUSE

Local, Professional,  
Computer Help  
and  
Support

[www.squeakymouse.com](http://www.squeakymouse.com)

01223 852872

[support@squeakymouse.com](mailto:support@squeakymouse.com)

## **“Protected land will be just that...” - but can we count on it?**

Firstly welcome to 2021 and may we see a noticeable recovery in all aspects of our personal and national life. And let's not forget several lovely characters from our village sadly no longer with us.

And so to the main topic: ...“pleasant open countryside being of ‘high’ landscape value.” This is how a Government Inspector described the meadow and the countryside beyond at the eastern end of the village at the time it was given the protection of Green Belt status. Much of our village countryside also sits within the Village Conservation Area and outside of the Development Envelope or Settlement Boundary, all of which may well become potential profit for predatory land owners if our planning officers cave in.

I wonder then how many of you know of or have even heard of the Green Belt, the Development Envelope or even the Conservation Area? Maybe many of you have, but are you familiar with the limitations they impose on what you can or cannot do on or to your property? All of these planning designations offer protection status to certain areas of land in the village and to the properties built thereon and or therein. The aim is to curb both property and land owners from inappropriate development or alteration, including even replacement windows, without formal planning approval. Moreover the objective is to ensure that these heritage and countryside assets are preserved and remain permanently open for future generations to enjoy; after all hasn't the openness and accessibility to our surrounding countryside been an absolute godsend to us over recent months. Unlike some villages roundabout we are fortunate to have three levels of protection we can count on – or can we?

If you happen to notice the Planning applications that appear in the Cresset you may have observed some applications seeking retrospective planning approval for development and or change of land use already carried out in one or more of these protected areas. In some cases transformations have taken place under perceived Permitted Development Rights known as PDR. Outside of protected areas the first you get to know about PDR development is when or after it has happened. And with PDR you have no right to prior planning consultation consequently; you could be subjected to a loss of amenity due to the dominance of a new building or the loss of an outlook (not view) as well as a number of statutory nuisances. Should there be a change of land use you might well be subjected to statutory nuisances such as noise, unsociable working hours, fires, parking issues and such like. But in a protected area any structural or land alteration, including PDR, must seek formal planning approval first!

So what defines these three levels of protection and what can or can't you do on or to your property?

Let's first look at the Development Envelope: DE's essentially protect the open countryside and agricultural land resources beyond from development, and conserve the

# COMPLETE PLASTERING

TILING • DRYLINING • ALL BUILDING WORK  
CARPENTRY • SCREEDING  
LIME PLASTERING • PAINTING & DECORATING

Covering all of Cambridgeshire

CONTACT: GLENN WARDER

TEL. 01223 811991  
MOB 07734 904050

E-MAIL: COMPLETEPLASTERING@MSN.COM  
RELIABLE SERVICE FREE ESTIMATES

## Chiropody

In your own home

Save £5  
off your first treatment  
when you present this advert.

Call **07905 267114** for an appointment

Daniel Harris BSc Hons MChS  
Fully qualified and Registered with Health Care Professions Council



*Continued from page 41*

character and landscape setting and promote sustainability.

Conservation Areas are defined as “areas of special architectural or historic interest, the character or appearance of which it is desirable to preserve and enhance”. Bottisham’s CA extends circa fifty meters along either side of the High Street from First Copy in the east to Holly Cottage (opposite Rank’s Garage) in the west. Crucially it removes owners’ rights to do works to their properties and or land without first obtaining planning permission. Owners must also give notice of their intention to carry out works to, amongst other things, trees and hedges.

Green Belt land takes the form of a protected ring of countryside around villages, towns and cities. The fundamental aim of the GB is to prevent urban sprawl by keeping GB land permanently open. Development is not approved except in ‘very special circumstances’.

A recent example of a ‘grab’ on the village’s protected areas is the proposed ‘Retirement Village with Affordable Homes’ - purported by the applicant to be a ‘very special circumstance’. If the planners support this and go against Local Plan policies then very little will be left of the working meadows and open countryside adorning this village, along with the loss of a biodiversity and the natural habitats it supports and protects.

“Preserve and enhance” is the conservation ethos. I am therefore somewhat bewildered that the East Cambs Conservation Officer does not consider the preservation and safeguarding of landscapes and green open spaces in protected areas part of his ‘Conservation’ remit – to quote; “I am a building conservationist, and I largely confine my observations to the physical impacts of proposals”. So having no objection to creating gaping great holes in ancient hedgerow in the High Street and allowing access and service roads across ‘high landscape value’ open countryside has no adverse conservation impact as long as buildings aren’t affected - really?

Hopefully you can appreciate just how important it is to get to know where these protected areas are and how their protection status can help you contest wrongful and or inappropriate expansion. As guardians of our heritage, perhaps we should take on a collective responsibility to ensure we protect these special areas for future generations rather than be guided by apathy!

*JOW*

**“...protected land will be just that – our green belt, areas of outstanding natural beauty and rich heritage - will be protected as the places, views and landscapes we cherish most and passed on to the next generation as set out in our manifesto.”**

Robert Jenrick Secretary of State for Housing – 2020.



Have you thought of advertising your business in **The Cresset**?  
Email the Editor for details: **BottishamCresset@gmail.com**

# ARCHITECTURAL DRAWINGS

FOR

PLANNING & BUILDING REGULATION APPLICATIONS

NEW PROPERTIES, EXTENSIONS, LOFT CONVERSIONS ETC

CONTACT US now to arrange a FREE on-site meeting at your convenience to discuss your project.

## ELY DESIGN GROUP

*'Architecture by Professionals'*

[www.elydesigngroup.co.uk](http://www.elydesigngroup.co.uk)

01353 649649

[mail@elydesigngroup.co.uk](mailto:mail@elydesigngroup.co.uk)

# Lloyds Gardens

**Friendly Affordable Reliable Gardening Service**

- All aspects of tree surgery
- Stump grinding
- Root ball removal
- Tree houses
- Garden Structures
- Bespoke clay pizza ovens

FULLY ACCREDITED AND INSURED

ALL WORK CARRIED OUT TO BS 3998 STANDARD

MANY HAPPY REFERENCES AVAILABLE ON REQUEST

Tel: 01638 744140

Mob: 07811 132709

[WWW.LLOYDSGARDENS.ME.UK](http://WWW.LLOYDSGARDENS.ME.UK)



“We do what it says on the tin” – EAAA is a rapid response organisation committed, ‘at the drop of a hat’ to attend all manner of emergencies whenever and wherever the need arises.

Picture the WW11 RAF pilots and groundcrews waiting at dispersal for the call to come. Whilst no-one rings a loud bell we rely on the telephone to task our two helicopters to embark on yet more potentially life-saving missions. Dramatic isn’t it ? Yes, very much so – urgency is the watchword backed up by a wide range of skillsets, training and experience.

As I ‘pen’ this it is grey and cold – we’ve had snow, high winds and excessive rain – so its good to hunker down in the comfort and warmth of our homes. Not our crews, doctors and paramedics though – they are ‘out there’.

Since inception and as of 9th December, in 2000, EAAA have attended 29,879 incidents – virtually 1500 per year. WOW ! This costs money – LOTS of money. I reported in December how we are coping but we need to do more than just cope. Demands on the services of all Air Ambulances, not just EAAA, are increasing. We are now also engaged in transporting seriously ill Covid patients to the best hospitals for their survival needs.

Therefore, we do need to continue raising funds to continue our service to the community. How might you help ? Lots of ways – join our lottery, provide a gift in your will, or simply donate – please.

We have just received nearly £2,000 – proceeds from three people making a parachute jump in Norfolk. Fancy it ? Get in touch. We will have another super raffle in February/March but, perhaps, most of all we need lots more volunteers. Its good fun, satisfying work in the knowledge that you would be making a difference.. Please go to our website to get in touch – there will be much to do in 2021- why not be a part of our great support teams at East Anglian Air Ambulance ?

*Michael White*

## **LOOKING FOR A REWARDING JOB IN YOUR COMMUNITY?**

**ARE YOU RECENTLY RETIRED? MOVED TO PART-TIME WORK? CHILDREN NOW AT SCHOOL?**

If you like meeting people and are able to deal sympathetically with elderly and frail people a vacancy exists for the post of Clerk to the Trustees following the retirement of the current post holder. Some simple book-keeping, dealing with electronic payments, a high level of confidentiality, minute taking and basic administrative duties are required. The successful applicant will receive any help and mentoring required for the first distribution.

An honorarium is attached.

Please apply in the first instance to: Coral Hatley  
Bottisham Local Charities, 29 Mill Road, Lode. CB25 9EN  
Or E-mail to coralhatley@gmail.com

**POWER CONTROL PANELS  
(CAMBRIDGE) Ltd.**

Also trading as  
**DB Electrical & Building Services**

**Dale Badcock**  
07718 122538

dale.pcp@gmail.com



**All domestic work undertaken**

- Rewiring
- Lighting
- Burglar alarms
- Security lighting
- Lighting design
- Controls Specialist
- Renovations
- Alterations
- Kitchens & Bathrooms

Unit 2 Barnwell Business Park  
Cambridge CB5 8UX  
01223 212054  
powercontrolpanels@gmail.com



*Rebecca Golding*  
*now has her new salon*  
*in Burwell*

*Tues*  
*9.30am-8pm*

*Thurs*  
*9.30am-8pm*



*30 Years'*  
*Experience*  
*All aspects of*  
*Hairdressing*

*Tel. 07742 997474*

*Free Parking at*  
*67 Silver Street*  
*Burwell, CB25 0EF*



**TIM PHILLIPS  
& Co.  
Accountants**

Independent, specialist service for:  
**Small Business • Self Assessment  
Personal Taxation**

Free initial consultation – no obligation  
**EASY, FREE PARKING**

Copley Hill Business Park, Cambridge Rd., Babraham  
Off A1307 between Wandlebury and Babraham

**Tel: 01223 830044. [www.tpaccounts.co.uk](http://www.tpaccounts.co.uk)**

# ***Bottisham Adult Learning Association (BALA)***

We are beginning the new year with some good news. We have the opportunity to book an online course for next term. This will be delivered by Zoom and will be charged per household.

The subject of the course will be 'Russian Music' given by Marina Burrell, a tutor familiar to us. When we were a WEA branch she presented two courses on Russian History and more recently a course on Russian Women. She has always proved popular with our learners and we can be confident she will deliver a very interesting course. She has done training on delivering online courses and has completed four successful Zoom – based courses.

The term will start on Thursday 14th January (10.30 – 12.30 with a short break) and will finish on 25th March. There will be no session on 18th February (a break for half term). The cost will be £35 per household. If you are interested in this course please book early as there are only 25 screens available by emailing [bottishambala@btinternet.com](mailto:bottishambala@btinternet.com)

We hope this will be of interest to you and a good start for 2021.

*Helen Cole*



**The Bell Bottisham**

**Serving Home Cooked Meals Wednesday to Friday Lunchtimes  
and Sunday Roast**

**Takeaway food available during the above times.**

**Other times bring a takeaway to Eat-In with us.  
Just book a table for your drinks, collect your takeaway, we will  
supply tableware and condiments  
Come in and enjoy**

**Strictly bookings only  
Call the Team on 01223 811483**

The opening times are;

<b>Lunchtimes</b> Wednesday to Friday 12am - 2pm, Sunday 12am - 3pm	<b>Evenings</b> Monday to Friday 5pm - Close Saturday 4pm - Close Sunday 5pm to Close
---	--



# J&J DRAKE



## Fully approved electrical contractor

- All Work Certificated in Accordance with NICEIC
- Free no obligation quotations
- All aspects of electrical work undertaken such as re-wires, Periodic test and inspections, maintenance calls, New build Installations.
- However small you may consider your job it will be treated with the same attention to detail as every one of our jobs.

## Your Local Electrician

Unit 24, Hall Barn Road Industrial Estate, Isleham, Ely, Cambs. CB7 5RJ  
Contact us on: 01638 781567 / enquiries@jandjdrake.co.uk



## Specialists in Military Fine Art & Framing

- Gallery open by prior arrangement
- All types of framing undertaken to match your budget
- Latest prints & rare secondary market art
- Military art collections purchased
- Find us on Facebook

## Gallery & Framing Services at 83 Longmeadow, Lode

[www.merlinaviationart.com](http://www.merlinaviationart.com)

Email: [hello@merlinaviationart.com](mailto:hello@merlinaviationart.com)

Tel: 01223 751545

T  
P  
M



**Taylored  
Property  
Management**

Your letting property is a key asset in your life, ARE you getting full value from it?

If you are not and you want a service that will release it's full potential and a free rental appraisal then come to the people that are able to offer you a "Taylored" package to suit your needs.

We offer a full comprehensive property management service, just as though the property was our own all at affordable rates to suit you:

**FREE** Energy performance certificate

**FREE** Initial letting fee

For your own personal service contact

Steve Taylor on 01638 741717 or 07753 272765 or email [steve@tayloredpm.co.uk](mailto:steve@tayloredpm.co.uk)  
9 Station Gate, Burwell, CB25 0BZ



**CHAPEL  
DENTAL**

84 Angle End  
Gt. Wilbraham  
CB21 5JG

Tel: 01223 811844

**Claire Jackman BDS & Associates**

NHS, DENPLAN & PRIVATE TREATMENTS

With special interests in implants and orthodontics

Monday / Wednesday / Thursday / Friday 09.00-17.00

Tuesday 09.00-17.00 Saturday 09.30-15.00

**New Patients Always Welcome**

[www.chapel.dental](http://www.chapel.dental)

# REFLEXOLOGY

For Health and Vitality

Reflexology has been  
an effective treatment for:

- Migraine • Back Pain • Infertility • Arthritis
- Sleep Disorders • Hormonal Disorders (Including PMT) • Sports Injuries • Digestive Disorders • Relaxation • Stress Related Conditions (exams, work, home, life) • Little people in nappies! (BabyFlex) • Men and Women, young and old.

**Jennie A Fatibene** MAR MBFVEA

Tel: 01223 811045

\*\* Gift vouchers available \*\*

# BURWELL COMPUTERS

*SUPPORT  
SALES  
REPAIRS*

 **01638 742702**

 **07901 556895**

[support@burwellcomputers.co.uk](mailto:support@burwellcomputers.co.uk)  
[www.burwellcomputers.co.uk](http://www.burwellcomputers.co.uk)

**At Wired we don't have problems - only solutions**



We offer solutions for all your Aerial, Freesat, CCTV, Telephone and Data Cabling needs.

No job is too big or too small for our engineers.

With no call centres, you will be able to speak directly to the engineer.

We offer an efficient, cost effective and friendly service.

Contact us now for a no obligation quote.

**Contact us NOW for a free no obligation quote**

**01638 281234 / 07761 572186**

[www.allwired.co.uk](http://www.allwired.co.uk)

[info@allwired.co.uk](mailto:info@allwired.co.uk)





# **My Village Handyman Services**

- DIY repairs and odd jobs
- Painting & Decorating
- Tiling, Flooring & Patios
- Gardening, Landscaping, Fencing & Decking
- Kitchen & Bathroom installation
- Brickwork, Dry Walling and Small Builds
- Carpentry and Plumbing
- Window and Gutter cleaning
- Jet wash and Patio cleaning
- Rubbish clearance and Tip runs
- Carpet cleaning and Wood Floor staining
- New doors or locks
- TV and Audio Installations
- Security and Garden lighting
- **No job is too Small or too Big!**

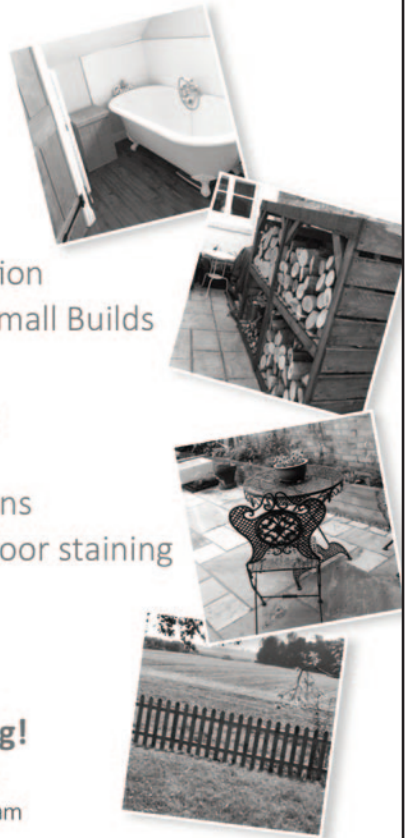

Free no obligation quotes and advice provided  
Your very local Handyman from Great Wilbraham

Contact us to arrange a visit or quote  
**07484 637084** or **01223 881700**

Email: [info@myvillagehandyman.com](mailto:info@myvillagehandyman.com) | [www.myvillagehandyman.com](http://www.myvillagehandyman.com)

# HARRISONS OF BURWELL LTD

**Plumbing and Heating**

*FREE ESTIMATES GIVEN*

Gas Boiler Servicing

**Clarence House, 7 Ness Road, Burwell, Cambs CB25 0AA**  
**Telephone: Newmarket 01638 742873 - Mobile 07932 773515**  
**email: harrisonsofburwell@gmail.com**

Gas Safe Registered

# HAYDEN

**THE CLEANING SPECIALIST**

Merrywood  
8 Lode Rd. Bottisham CB25 9DJ  
01223 813766 or 07919561665  
Email: [hayden.woodruff@btinternet.com](mailto:hayden.woodruff@btinternet.com)

WOULD YOU LIKE YOUR CARPETS  
OR UPHOLSTERY CLEANED?

HAYDEN IS LOCAL TO THE AREA,  
OFFERING FREE QUOTATIONS  
AND ADVICE

WE ALSO CLEAN WINDOWS WITH  
OUR NEW REACH AND WASH  
SYSTEM OR TRADITIONAL, YOUR  
CHOICE

## k-domestic electrical solutions



Complete installations & rewires  
Small and large alterations  
Lighting  
Internal & External work  
PAT testing  
Periodic Inspection & Reports  
Full Inspection, Testing,  
Verification & Certificate issue  
LED  
Under Floor Heating  
Voltage Optimization

your **local** electrical service of choice and recommendation

**Karl Howe**  
**01638 610438 M: 07541 008613**

Email: [enquire@k-elecsolutions.com](mailto:enquire@k-elecsolutions.com) Website: [www.k-elecsolutions.com](http://www.k-elecsolutions.com)

Fully qualified Part P and 17th Edition

**City &  
Guilds**  
Qualified



# NEED A NEW FENCE ?

- Reliable local company. Established 2007.
- Over 1000 local installations.
- Choice of colours & sizes.
- NEVER PAINT A FENCE AGAIN.
- Will withstand storm force winds.
- 25 years guaranteed product.
- Numerous local testimonials available.



For a **free, no obligation**, site survey and quote.

Call us now on 01223 811160

[www.colourfencecambs.co.uk](http://www.colourfencecambs.co.uk)

## Bottisham Vehicle Services Ltd.

Reliable, Friendly, Professional

Service and repairs to all makes,

MOT testing, tyres, air conditioning

Courtesy car available

Local collection and delivery

10 Tunbridge Lane, Bottisham, Cambridge CB25 9DU

01223 811919 • [simon@bvsltd.net](mailto:simon@bvsltd.net) • [www.bvsltd.net](http://www.bvsltd.net)

# Your Friendly, Local Wood Burning Stove Specialist'



## VISIT OUR SHOWROOM!

**Whitelands Farm  
Newmarket Road  
Bottisham  
Cambridge  
CB25 9BD**

**COVID-19 Update – We are currently operating our showroom on an appointment only basis, please email or phone to arrange.**

**\*Mon – Fri - Appointment Only**

**\*Sat – Appointment Only**

**\*Sun – Closed**



**01223 703184**

Email: [sarah@cambridgestoves.co.uk](mailto:sarah@cambridgestoves.co.uk)

[www.cambridgestoves.co.uk](http://www.cambridgestoves.co.uk)

CALL NOW FOR YOUR FREE, NO OBLIGATION SURVEY AND QUOTATION, OR MAKE AN APPOINTMENT TO VISIT OUR SHOWROOM

ALL ASPECTS OF BUILDING WORKS TO YOUR FIREPLACE UNDERTAKEN

FAST, RELIABLE AND EFFICIENT SERVICE CARRIED OUT BY QUALIFIED HETAS ENGINEERS

LARGE SELECTION OF WOOD BURNING STOVES ON DISPLAY



# MOBILITY EQUIPMENT

STAIRLIFTS, SCOOTERS, WHEELCHAIRS, RISING CHAIRS AND  
BEDS, WALKERS, TOILET & BATHING AIDS, KITCHEN &  
HOUSEHOLD AIDS, CONTINENCE CARE, FOOTWEAR

SPARES, SERVICE, HIRE OF EQUIPMENT  
HOME VISITS AVAILABLE  
FRIENDLY AND CONSIDERATE SERVICE GUARANTEED



SCOTSDALES GARDEN CENTRE  
HORNINGSEA  
CB25 9JG  
01223 863908  
[www.orchard-mobility.co.uk](http://www.orchard-mobility.co.uk)

Monday to Saturday 9.00 – 5.00

## Bottisham Parish Council

### CHAIR

JON OGBORN

### VICE CHAIR

WILLIAM CLARKE

### PARISH COUNCILLOR

HILDA BUCHANAN

LEE CHETWYND

LINO DI LORENZO

VICTORIA MARSH

PETER MARTIN

STEVEN O'DELL

BILL SUNNER

LAURIE VAN SOMEREN

NEIL WINKCUP

### DISTRICT COUNCILLO

CHARLOTTE CANE

JOHN TRAPP

### COUNTY COUNCILLOF

MATHEW SHUTER

### PARISH CLERK

JONATHAN GILES

## BOTTISHAM COMMUNITY LIBRARY ASSOCIATION

### LIBRARY OPENING HOURS

TUESDAYS

6.00pm-8.00pm

THURSDAYS

3.00pm-5.00pm

SATURDAYS

10.00am-12.00am

*Working in Partnership with the  
County Library Service.*

## Useful Information

<b>Bottisham Website:</b> .....	WWW.BOTTISHAMPC.CO.UK
<b>Holy Trinity Church:</b> Revd Sue Giles .....	812726
<b>Roman Catholic Priest:</b> Monsignor Eugène Harkness. Parish of St Philip Howard .....	01223 211235
<b>RE:NEW/Lode Chapel:</b> Rev. Alan Brand .....	01223 812558
<b>Bottisham Surgery:</b> .....	
Enquiries and Appointments .....	810030
Out of Hours only - Urgentcare Cambridge .....	111
<b>Bottisham Library:</b> .....	812354
Library hours: Monday Closed; Tuesday 3-5pm and 6-8pm; Wednesday 10-11.30am Thursday 3-5pm; Friday 6-8pm; Saturday 10am-12noon	
<b>Cambridgeshire Police HQ:</b> .....	01480 456111
<b>Cambridgeshire Police:</b> .....	(NON-URGENT MATTERS) ring 101 - In EMERGENCIES ring 999
Police community support officer Ann Austin PCSO 7353 at Ely Police Station ....	Contact through 101
<b>1st Bottisham Rainbows/1st Bottisham Brownies:</b> Kay Pearce .....	811055
<b>Bottisham &amp; District Gardening Club:</b> Secretary: Julia Green .....	811467
<b>Bottisham Bowling Club:</b> Keith Gibson, Secretary .....	811049
<b>Bottisham Carpet Bowls Club:</b> Nora Watson .....	812121
<b>Bottisham Community Primary School:</b> .....	811235
<b>Bottisham Cricket Club:</b> Chairman: Will Allen .....	07801 580604
<b>Bottisham Local Charities Trustees:</b> Clerk - Coral Hatley .....	811457
<b>Bottisham Pharmacy:</b> .....	812321
<b>Bottisham Pool Association:</b> Manager - Jason Rye .....	811121
<b>Bottisham Royal British Legion Branch:</b> Secretary. Peter Walker .....	811402
Branch Chairman: Dave Frost .....	www.Britishlegion.org.uk/branches/bottisham
<b>Bottisham Scout Group:</b> Group Contact: Linda Jones .....	813040
<b>Bottisham Community Sports and Social Club:</b> Secretary Graham Darling, Bottishamcsasc@gmail.com .....	812063
<b>Bottisham Village College, School:</b> .....	811250
Evening Classes, Clubs and Youth Club Information .....	811372
<b>Bottisham W.I.:</b> Secretary - Jenn White • mrandjw@btinternet.com .....	811600
<b>Bottisham Youth Football Club:</b> Jim Tideswell .....	812591
<b>Cambridgeshire County Councillor:</b> Mathew Shuter .....	01638 508729
<b>East Cambridgeshire District Offices:</b> .....	01353 665555
<b>East Cambridgeshire District Councillors:</b> Charlotte Cane 34 Swaffham Road, Reach .....	07976 607512
John Trapp 104 Commercial End, Swaffham Bulbeck .....	01223 812120
<b>Girlguiding Bottisham District:</b> Cambs East County office • www.cambseastguides.org.uk .....	01223 813917
<b>Parish Council Chairman:</b> Jon Ogborn .....	07486 372780
<b>Parish Council Clerk:</b> Jonathan Giles .....	07789 012761
<b>Queen's Court Day Centre:</b> .....	811905
<b>MP for Cambs South East Constituency:</b> Lucy Frazer, House of Commons, London SW1A 0AA .....	
E. lucy.frazer.mp@parliament.uk W. www.lucyfrazer.org.uk	
<b>Cambridgeshire Trading Standards Helpdesk:</b> .....	0845 3030666
<b>Saplings Preschool:</b> .....	813226
<b>Milton Road Tip:</b> Apr to Sept - Weekdays 9.00am-8.00pm: Weekends 9.00am-6.00pm .....	860674
Oct to Mar - 9.00am-4.00pm	
<b>CRESSET Editor:</b> .....	email: BottishamCresset@gmail.com
<b>Treasurer, Advertising rates and payment:</b> Rhona Walker, 94 High Street, Bottisham .....	811402
<b>Distribution:</b> Ian & Helen Cole .....	812573
<b>Design/Artwork:</b> ONG (Old Newton Graphics) • www.codge.com .....	01449 675548

**The Cresset:** While every effort is made to ensure accuracy we cannot accept liability for any mistakes or misprints. The views of, or any opinions expressed, are **not** those of the EDITOR. The Editor cannot accept any responsibility for statements made in advertisements.

# MANCHETTS

Car Truck & Van Centre



# Van Hire from £49

**01638 661113**

***www.manchetts.co.uk***

*1 Victoria Way Studlands Industrial Estate Newmarket Suffolk CB8 7SH*

# E.C. AUTOCARE

(Est. 1980)



**SERVICING & REPAIRS**  
Cars & Light Commercials  
Diesel & Petrol



## MOT TESTING STATION

**Servicing to all makes of Cars  
& Light Commercials**

- ✚ **ENGINE MANAGEMENT DIAGNOSTICS**
- ✚ **TYRE - BRAKES - EXHAUSTS**
- ✚ **AIR CONDITIONING SERVICING**
- ✚ **GEARBOX SPECIALISTS** MANUAL & AUTOMATIC

**FAST, FRIENDLY, FAMILY BUSINESS**

**56 HIGH STREET, BOTTISHAM**

Also at

**A1303 SERVICE STATION, BOTTISHAM**  
(behind Brian McKay)

**Tel.01223 811122 or 01223 812357**

